

Alpha



commercialimages
evolving workspaces

Alpha has been thoughtfully designed to achieve a creative work environment. Strong lines and a sense of structure coupled with a relaxed style, encourages team work and collaboration within the office

Alpha is compatible with all of our screens systems . If you're after a lighter look and feel pair with our Ozone screen or frameless acrylic. If structured solid look is required it can be paired with our Exe Series screens incorporating integrated ducting. Please turn over for specification guide.



Creating the perfect workstation is now easy with Bevisco's integrated design approach. This holistic concept allows you to mix and match components & accessories across our range of systems. You can now balance function, aesthetics and cost like never before.



Alpha

specification guide

Available Sizes

Single Sided	Double Sided
600mmD	1530mmD
700mmD	1600mmD
750mmD	
800mmD	
850mmD	

Notes:
Worktops cantilever over workstation frame.
Sizes noted above are worktop sizes. Actual frame sizes are 600, 750, 1530mm

Available in lengths up to 2400mmL

Colours

Alpha is stocked in white powder coat.

Custom colours available

Lead Times:

4 weeks

Lead times above are indicative only. Lead times are subject to availability of materials and production capacity

Accessories

Suitable with all of Bevisco's accessories range. Refer to brochure for full details.

Configurations

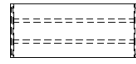

Rectangular Freestanding

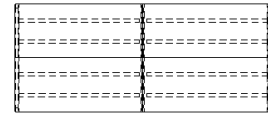

Rectangular Cluster (2, 4, 6 or 8 workstations)

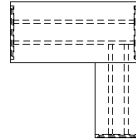

L-Shaped Freestanding

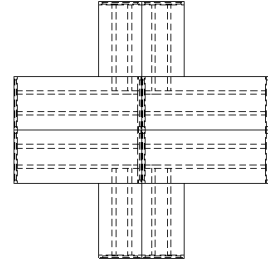

L-Shape cluster (2, 4, 6 or 8 workstations)

Screen Options

Frameless Acrylic Panel

Frameless Echo Panel

30, 50 or 75mm aluminium framed screen

Custom - made to specification

Leg Profile:

50mm x 25mm trapezoidal section with floating top detail



Section through leg

